

## Vision system **NV-Pro**

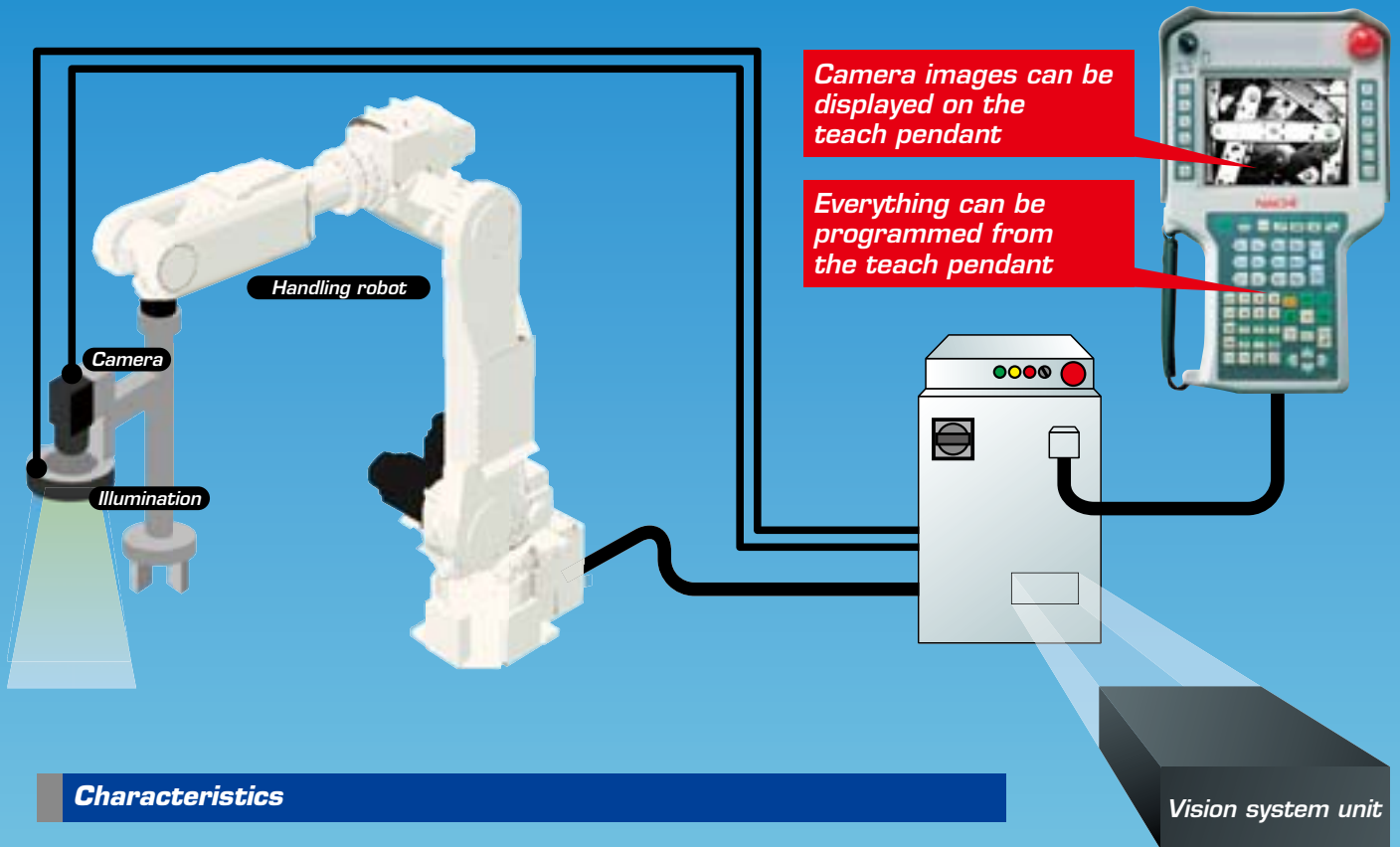

### Characteristics

- Vision system is built into the controller and the teach pendant is easy to use
- Automatic exposure function improves resistance to ambient light by four times
- Improved hardware performance and faster I/O control greatly shortens measuring time  
(comparison with our existing model: 2D is 60% and 3D is 83% faster)

### Improved resistance to ambient light

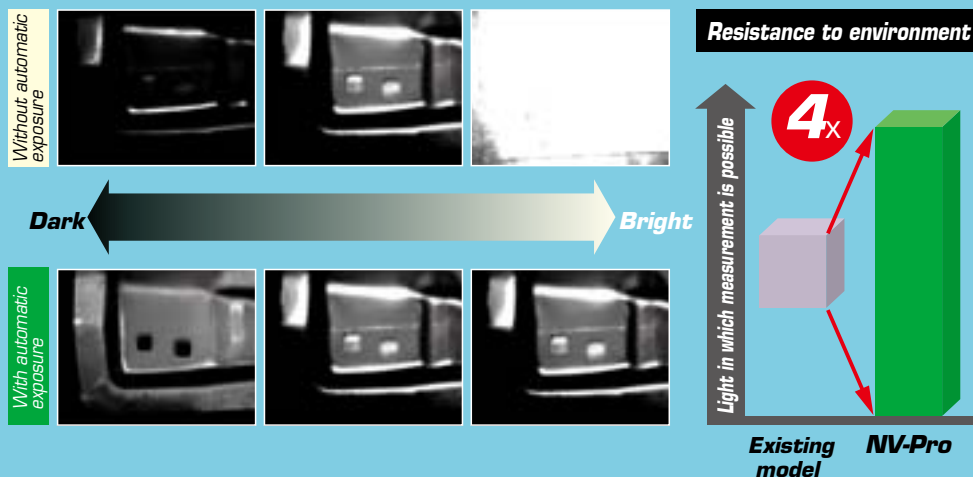

### Measuring time shortened

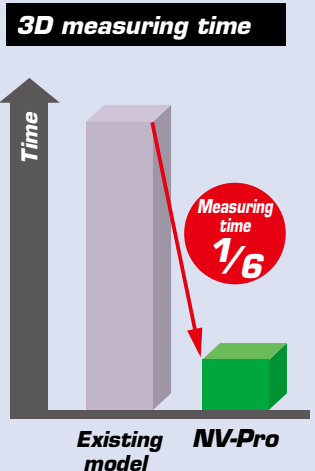

# Vision system **NV-Pro**

## Basic specifications

Item	Specifications	
Image input	Camera compatibility	Black and white 640 (W)×480 (H) (maximum black and white 1600 (W)×1200 (H))
	Number of connected cameras	4
Measuring conditions	Possible number of records	Maximum 999
	Exposure time	Settable/automatic control*
	Illumination	Illumination is selectable
	Retry	Yes (exposure conditions are changeable)
	Search area	Any shape from combination of rectangle and oval
	2 dimensional	Blob analysis, rotating search
3 dimensional (option)	Stereo, close laser	
Measuring	Measuring start method	Function of robot program
	Compensation amount acquisition method	
	Compensation method	World coordinate standard/flange coordinate standard
Peripheral equipment	Operation	Operation through teach pendant
	Data storage	Compact flash
	I/O signal	8 points trigger input, illumination/16 points laser control output
Environment conditions	Ambient temperature	0 to 45°C
	Ambient humidity	20 to 85% RH (without condensation)

\* Some cameras cannot be controlled automatically or have the exposure time set.

## Example of application using automatic exposure function

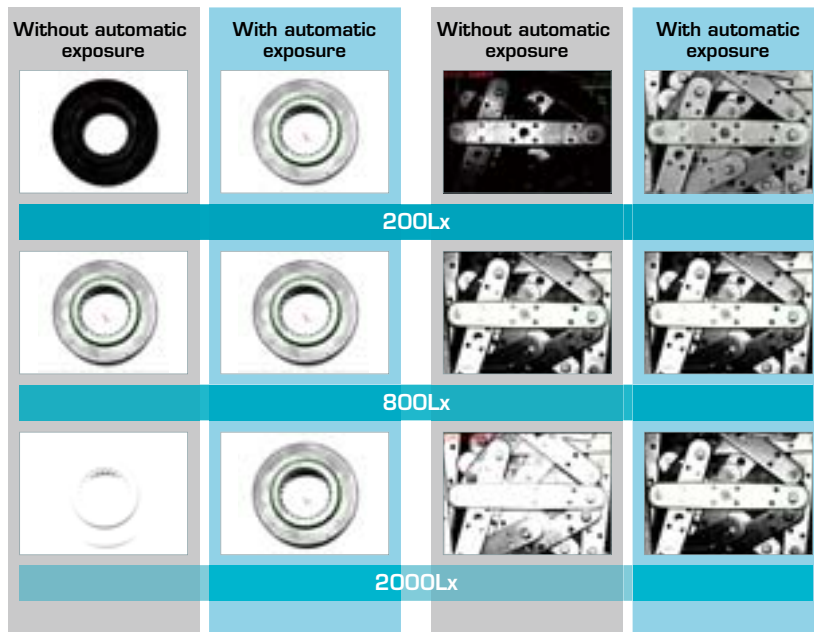

## Example application

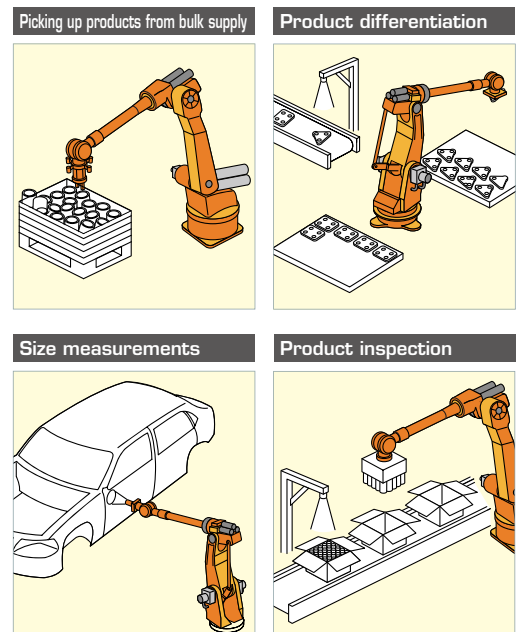

# NACHI

<http://www.nachi.com/>

## NACHI-FUJIKOSHI CORP.

Tokyo Head Office Shiodome Sumitomo Bldg. 17F, 1-9-2 Higashi-Shinbashi, Minato-ku, Tokyo 105-0021, JAPAN  
 Toyama Head Office 1-1-1 Fujikoshi-Honmachi, Toyama 930-8511, JAPAN

Tel:+81-(0)3-5568-5245  
 Tel:+81-(0)76-423-5111

Fax:+81-(0)3-5568-5236  
 Fax:+81-(0)76-493-5211

NACHI ROBOTIC SYSTEMS INC. <http://www.nachirobotics.com/>  
 NACHI EUROPE GmbH  
 NACHI-FUJIKOSHI CORP. THAILAND REPRESENTATIVE OFFICE  
 NACHI BRASIL LTDA.  
 NACHI (AUSTRALIA) PTY. LTD.

Tel:+1-248-305-6545  
 Tel:+49-(0)2151-65046-0  
 Tel:+66-2-714-0008  
 Tel:+55-11-4793-8800  
 Tel:+61-(0)2-9898-1511

Fax:+1-248-305-6542  
 Fax:+49-(0)2151-65046-90  
 Fax:+66-2-714-0740  
 Fax:+55-11-4793-8870  
 Fax:+61-(0)2-9898-1678

Specifications and configurations may change without notice due to product developments.

CATALOG NO.

R7020E

2011.11.X-MIZUNO